

Collettori solari piani certificati EN 12975. Cassa in profilato di alluminio verniciato colore testa di moro, isolamento termico in lana di roccia alta densità 45 mm, piastra solare captante interamente in rame con tubi collettori diametro 22 mm, assorbitore a lastra totale con trattamento altamente selettivo al titanio saldata ad ultrasuono. Vetro prismatico, temperato ad elevata trasparenza, antiriflesso.

*Flat solar collectors EN 12975 certified. Dark brown painted aluminum, section case with 45 mm rock wool thermal insulation, copper solar plate with 22 mm diameter pipes, absorber plate with highly selective titan treating and ultrasonic welding, extra light anti-reflex tempered prismatic glass.*

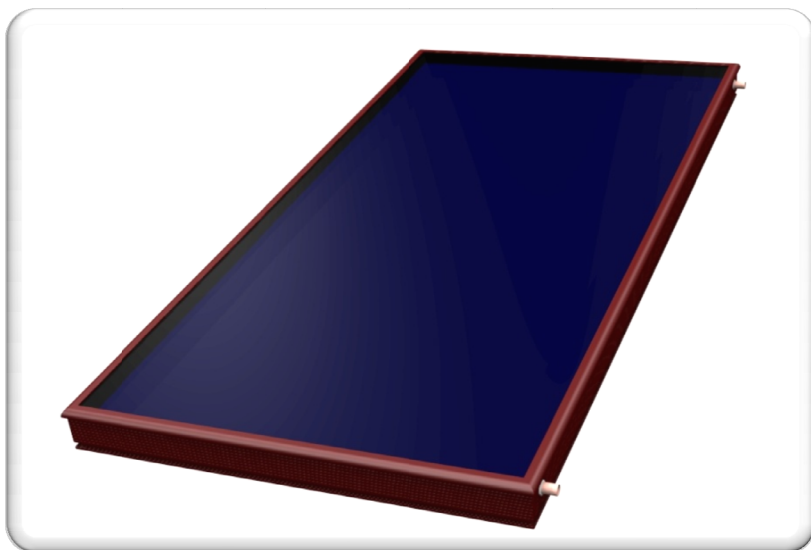

**Certificazioni - Certifications**

**Collettori Solari testati secondo gli standard europei EN 12975**

*Solar collectors tested in compliance with EN 12975 European Standard*



**Curva di rendimento**

*Efficiency curve*

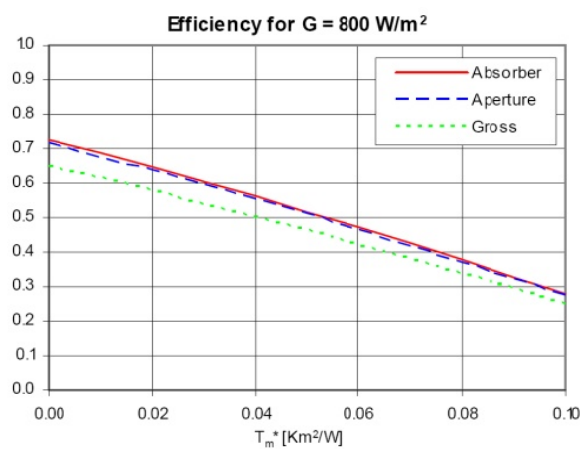
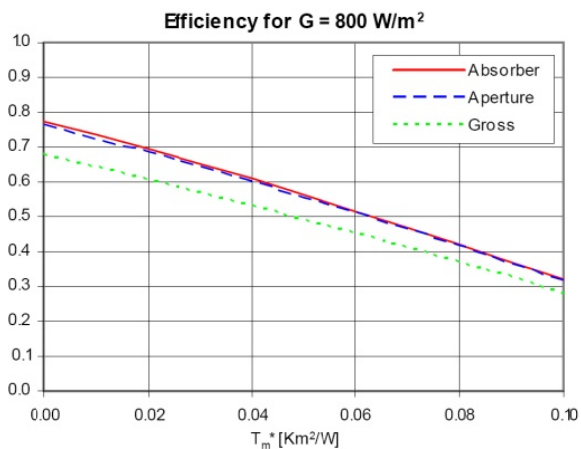

**Perdite di Carico [Pa]**

*Pressure drop [Pa]*

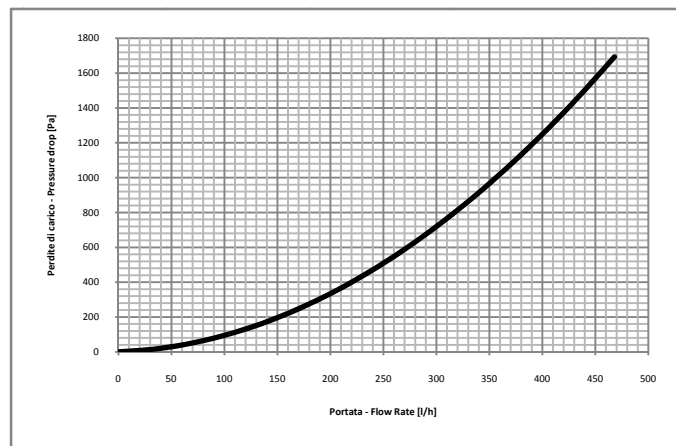
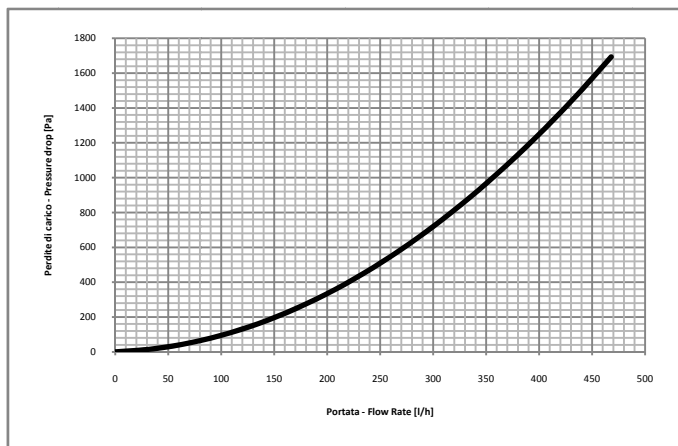

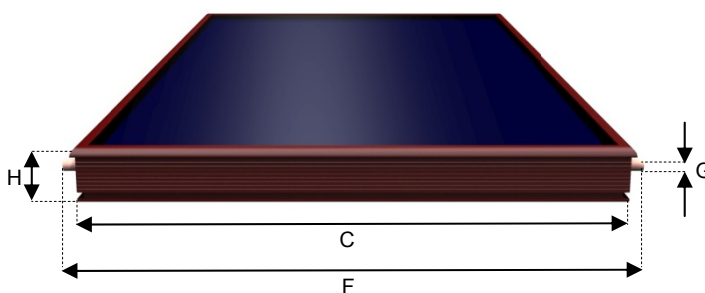
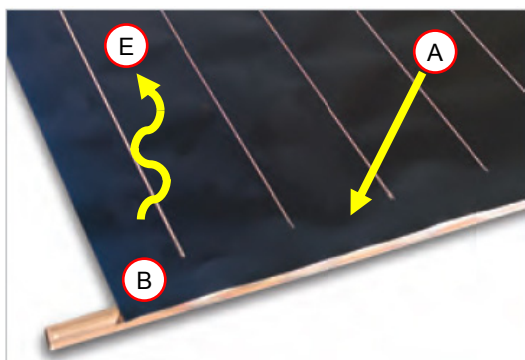
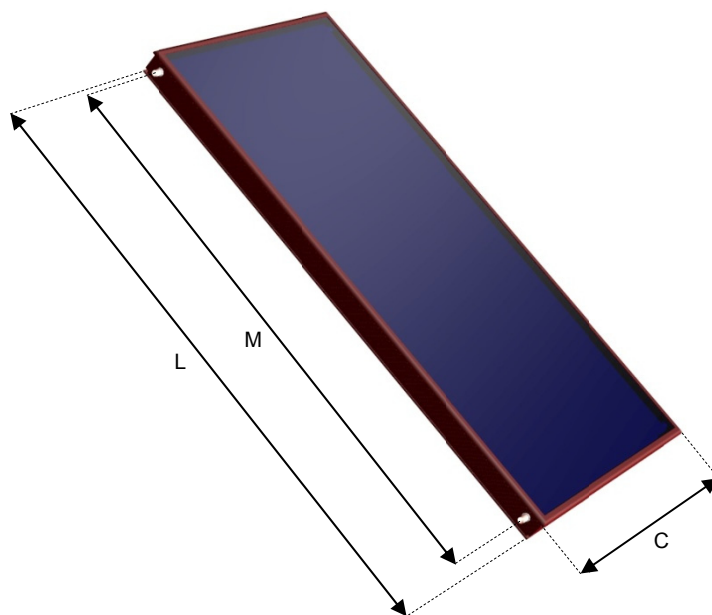
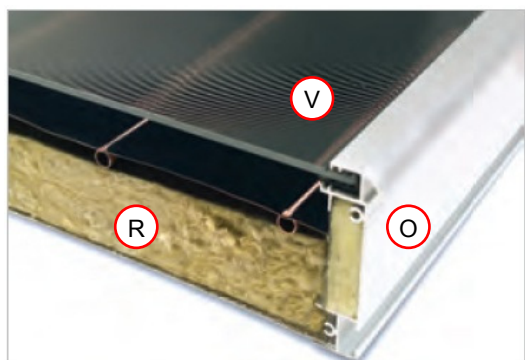

Caratteristiche	Rif.	Unità di misura	H1T	H1TX
Dimensioni - Size	L	mm	2007	2005
	C	mm	1008	1290
	H	mm	100	102
Peso - Weight		kg	39,5	50
Diametro tubi collettore - Diameter collector pipes	G	mm	22	22
Lunghezza tubo - Pipe length	F	mm	1050	1340
Distanza tubi - Pipes distance	M	mm	1880	1880
Colore standard cassa - Case standard color	O		Marrone - Brown	
Materiale cassa - Casing material	O		Alluminio - Aluminum	
Spessore isolamento - Insulation thickness	R	mm	45	45
Vetro - Glass	V		Extra chiaro, temperato, prismatico Extra light, tempered, prismatic	
Superficie assorbente netta - Net absorbent surface		m <sup>2</sup>	1,767	2,305
Superficie di apertura - Aperture surface		m <sup>2</sup>	1,797	2,345
Superficie totale collettore - Gross collector surface		m <sup>2</sup>	2,023	2,586
Materiale piastra assorbente Absorbent plate material	B		Rame - Copper	
Trattamento superficiale - Surface coating	B		Selettivo TITAN - Selective TITAN	
Assorbimento - Absorption	A	%	95	95
Emissione - Emission	E	%	5	5
Portata consigliata a pannello - Advised panel flow		lt/h	100	100
Capacità acqua collettore - Collector water capacity		lt	1,6	2
Massima pressione di esercizio Maximum working pressure		bar	10	10